

CTFA-PB

CW THULIUM FIBER AMPLIFIER

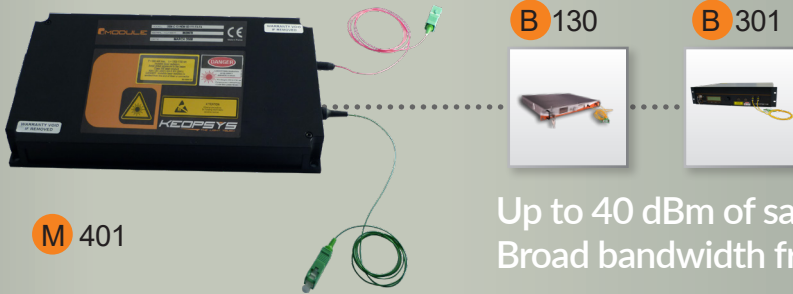

2.0 μm



Up to 40 dBm of saturated output power ,
Broad bandwidth from 1900 to 2050 nm,
...

Thulium fiber amplifier is designed for scientific and sensing applications between 1900 and 2050 nm. CTFA-PB series deliver up to 40 dBm of saturated output power with a weak input range signal. The design proposes wide or narrow wavelength ranges.

The high-power thulium fiber amplifiers are built with a pre-amplifier, which gives them an excellent output optical signal to noise ratio (OSNR).

Furthermore, the use of a single mode fiber guarantees a high beam quality which is a key factor for sensing applications.

These devices are accessible in random or polarization maintaining versions.

CTFA-PB is available in OEM module for integration applications or user-friendly benchtop for laboratories experiences.

The CTFA-PB amplifier is manufactured according a production process that gives to the device a high level of reliability.

Finally, the amplifier does not need specific installation. However, Lumibird will offer free support to its first start on request.

Key features

- Up to 40 dBm of saturated output power
- Broad bandwidth from 1900 to 2050 nm
- Choice of wavelength range
- Eye-safe operation
- Pre-amplifier built-in for good OSNR
- Polarization-maintaining (optional)
- Choice between turnkey benchtop or OEM module
- Diffraction limited output beam
- High reliability

What applications

- Remote sensing (LIDAR)
- Gas sensing
- Optical component testing
- Test and measurement
- Research & development

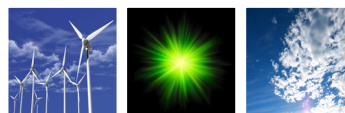

Modes of operation

The devices offer several modes of operation :

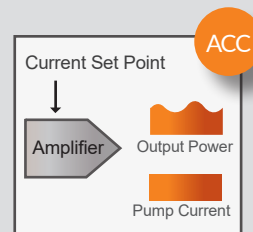

ACC (Automatic Current Control) mode is standard for all devices. The amplifier is controlled from diodes current set point.

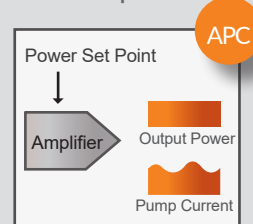

APC (Automatic Power Control) mode allows controlling the amplifier at a fixed output power set point. The device maintains a constant optical output power monitored with a photodiode. The current is adjusted automatically.

CTFA-PB

CW THULIUM FIBER AMPLIFIER



Optical Specifications @ 25 °C	CTFA-PB
Mode of operation	CW
Polarization	Random (SM) or linear (PM with PER>17 dB)
Output power (0 dBm input)	From 17 to 40 dBm
Wavelength range	1900 to 1930 nm (BW1), 1930 to 1960 nm (BW2), 1960 to 2000 nm (BW3), 2004nm +/-4 nm (BW4), 2040 +/-5 nm (BW5), 2050 +/-1 nm (BW6)
Input power range	0 to +10 dBm or 0 to +15 dBm
Input / output monitoring	Yes
Control mode	ACC / APC
APC tunability	30-100 %
Optical port fiber type	SMF28 or PANDA
Input / output termination	FC/APC, SC/APC, FC/SPC, SC/SPC

The CTFA-PB is available as turn-key benchtop or as OEM module.

RELIABILITY

The Lumibird range of fiber amplifiers are manufactured with tested components and are submitted to several inspections during the manufacturing process under a rigorous quality management certified in accordance with the ISO 9001:2015 standard. Our all-in-fiber systems offer maintenance-free operation. Countless units are continuously running in demanding environments with no failure.

GUARANTEE

Our fiber systems are under 1 full year parts and labor warranty. We offer a warranty extension of 1 or 2 years. Please contact us.

For ordering information and custom solutions, please contact us : websales@keopsys.com

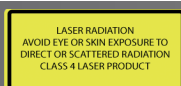

Lumibird undertakes a continuous and intensive product development program to ensure that its products perform to then highest technical standards. As a result, the specifications in this document are subject to change without notice.

Lumibird has locations across the globe that are available to provide support for any product, service or inquiry. Visit www.lumibird.com to connect with any of our global sites.

